

If you have built your own glossaries in EduLINC, you can export the entries in EduLINC and import them into your new Avenue course.

Exporting Items from a Teacher-built Glossary on EduLINC

1. In your EduLINC course, locate and click on a **glossary** link.



2. In the **Glossary Administration** menu, choose **Export Entries**.

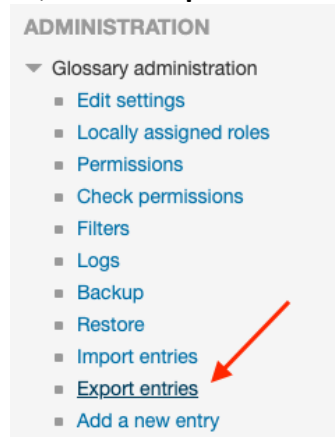

3. Click the **Export Entries to File** button.



The file is downloaded on your computer.

Importing Items to your Glossary on Avenue

1. In your Avenue course, locate and click on the same **glossary** link. The glossary contains no entries.

- In the **Glossary Action** menu, choose **Import Entries**.

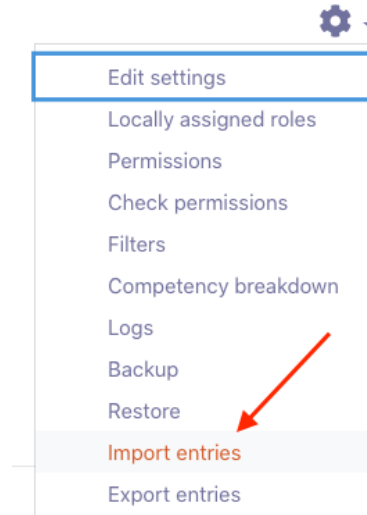

- Drag and drop the downloaded XML file into the Drag and Drop box.

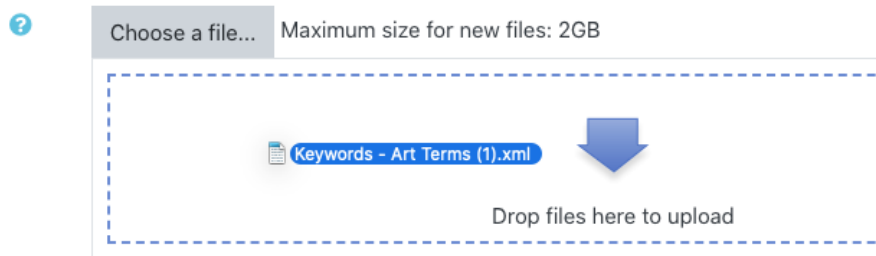

- On the **Import entries from XML file** page, click on the **Submit** button.

Import entries from XML file

File to import ?

Choose a file... Maximum size for new files: 2GB

Keywords - Art Terms (2).xml

Destination of imported entries ?

Current glossary ▾

Import categories

Submit ←

5. A confirmation screen appears. Click on the **Continue** button.

Import entries from XML file

Total entries: 82
Imported entries: 82

Continue

The new glossary appears with the **imported entries** from your EduLINC glossary. This includes images.

Glossary Import Help Links

[Moodle Documents: Import Glossary Entries](https://docs.moodle.org/39/en/Import_Glossary_Entries)

<https://docs.moodle.org/39/en/Import_glossary_entries>

[Moodle Documents: Glossary FAQs](https://docs.moodle.org/39/en/Glossary_FAQs)

<https://docs.moodle.org/39/en/Glossary_FAQ>